

TEL : 82-53-668-0255  
FAX : 82-53-668-0277  
AFS : RKRRYNYX  
E-mail : aais@korea.kr  
Web : http://ais.casa.go.kr

**REPUBLIC OF KOREA**  
**Ministry of Land, Infrastructure and Transport**  
**Office of Civil Aviation**  
11, Doum 6-ro, Sejong-si, 30103, Republic of Korea

**AIP**  
**Supplement 9/21**  
**6 MAY 2021**

**GEN : NIL**

**ENR : NIL**

**A D : JEJU/Jeongseok(RKPD)**

### UNSERVICEABILITY OF ILS/DME

#### 1. INTRODUCTION

The ILS/DME for RWY 01/19 at Jeongseok Aerodrome will be unserviceable due to replacement.

#### 2. PERIOD

From 1600 UTC 4 DEC 2019 To 1600 UTC 6 OCT 2021

#### 3. RADIO NAVIGATION AND LANDING AIDS INFO

Type of Aid, CAT of ILS/MLS	ID	Frequency	Position of Transmitting Antenna Coordinates
LOC 01	IJDG	108.3 MHz	33°24'22.7"N 126°42'41.2"E
GP 01	-	334.1 MHz	33°23'07.5"N 126°42'46.3"E
DME 01	-	981 MHz (CH 20X)	33°23'07.8"N 126°42'46.5"E

#### 4. WORKING AREA

See the diagram

#### 5. REMARKS

(1) During the replacement period, some flight procedures of RKPD will not be available as follows.

	RWY	Procedure	AIP Page
Instrument Approach	01	ILS RWY 01	RKPD AD CHART 2-13
		LOC RWY 01	RKPD AD CHART 2-14

(2) These cranes do not penetrate any obstacle limitation surfaces of RKPD.

(3) Any change to the contents of these pages will be notified by NOTAM.

*(AIP SUP 31/20 is hereby superseded)*

6. DIAGRAM

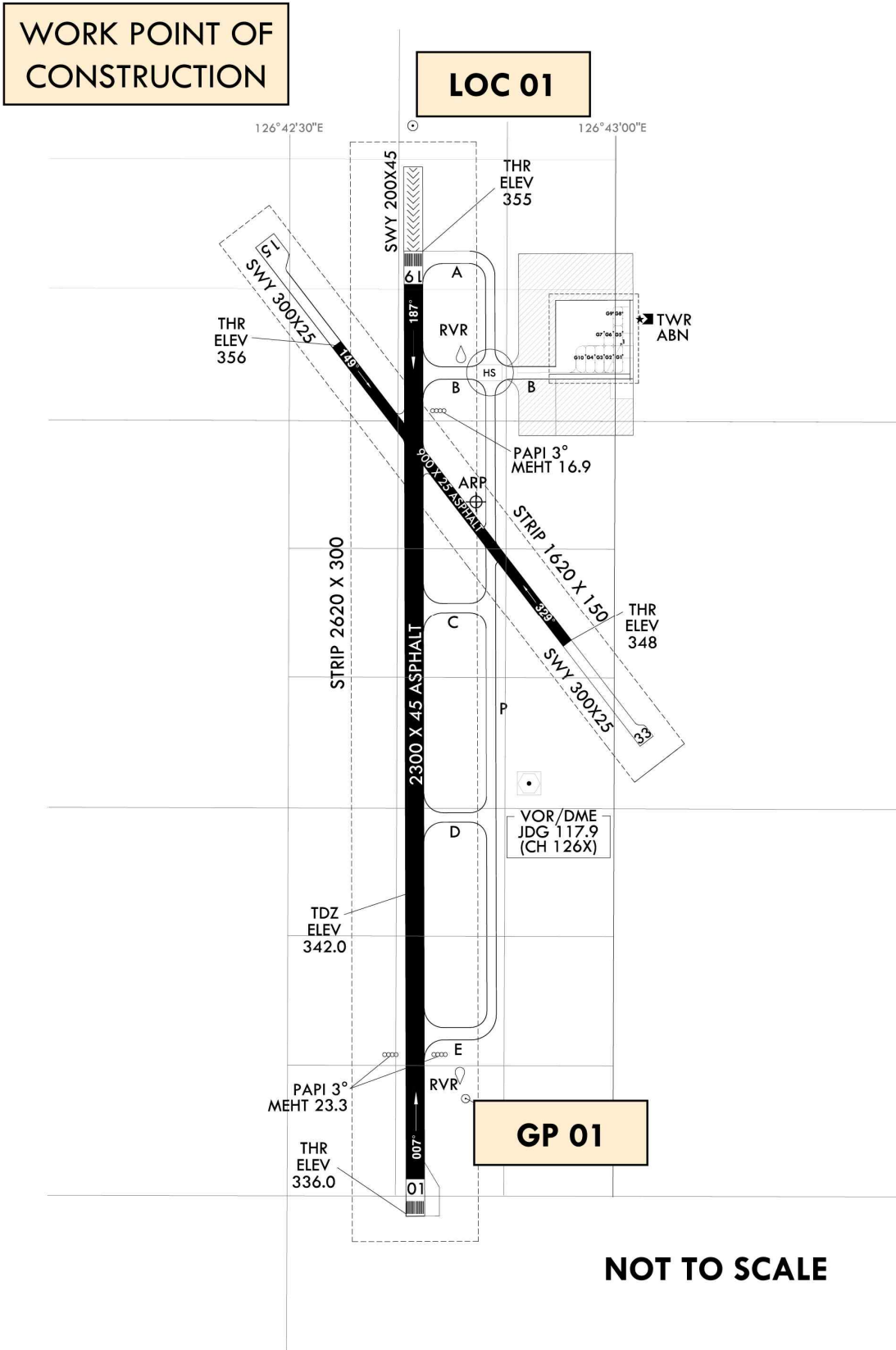

NOT TO SCALE